

MUNICIPALITY OF LAMBTON SHORES
 SCHEDULE "A-3" (PORT FRANKS)
 TO BY-LAW NO. 1 OF 2003

PASSED THIS 3 DAY OF February, 2003

J.C. IVEY, MAYOR

CAROL McKENZIE, CLERK

LEGEND

SYMBOL	ZONE
A1	AGRICULTURAL - 1
C11	COMMERCIAL - 11
C12	COMMERCIAL - 12
EP-H	ENVIRONMENTAL PROTECTION - HAZARD
EP-PF	ENVIRONMENTAL PROTECTION - PORT FRANKS
EP-WET	ENVIRONMENTAL PROTECTION - WETLAND
FD	FUTURE DEVELOPMENT
I1	INSTITUTIONAL - 1
OS1	OPEN SPACE - 1
OS2	OPEN SPACE - 2
R3	RESIDENTIAL - 3
R5	RESIDENTIAL - 5
R9	RESIDENTIAL - 9
R11	RESIDENTIAL - 11
-H1,-H2..	HOLDING PROVISIONS
-1,-2,..	EXCEPTIONS

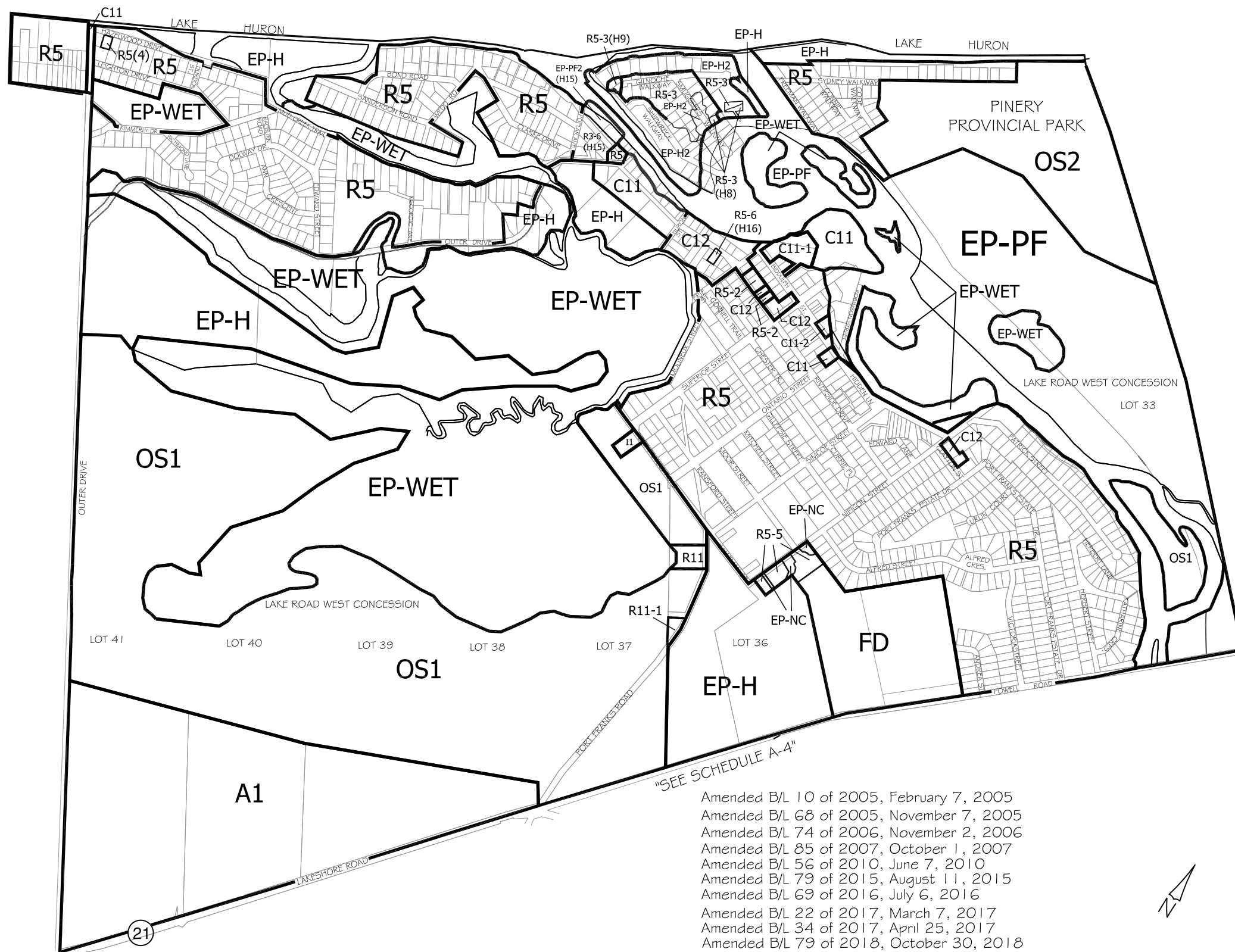

"SEE SCHEDULE A-4"

- Amended B/L 10 of 2005, February 7, 2005
- Amended B/L 68 of 2005, November 7, 2005
- Amended B/L 74 of 2006, November 2, 2006
- Amended B/L 85 of 2007, October 1, 2007
- Amended B/L 56 of 2010, June 7, 2010
- Amended B/L 79 of 2015, August 11, 2015
- Amended B/L 69 of 2016, July 6, 2016
- Amended B/L 22 of 2017, March 7, 2017
- Amended B/L 34 of 2017, April 25, 2017
- Amended B/L 79 of 2018, October 30, 2018



PREPARED BY:
 COUNTY OF LAMBTON
 PLANNING AND DEVELOPMENT DEPARTMENT
 FEBRUARY, 2003