

# The Municipality of Lambton Shores OFFICIAL PLAN SCHEDULE "A8" (Arkona)

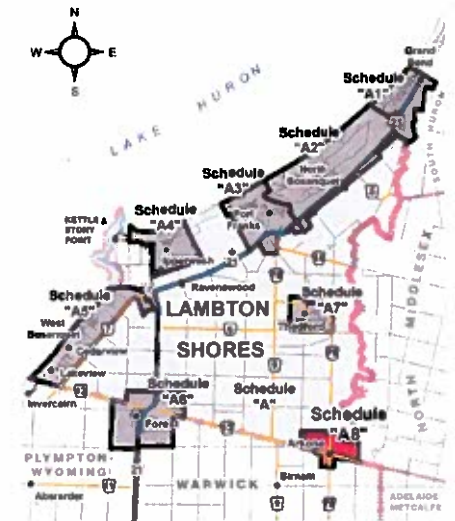

## The Municipality of Lambton Shores OFFICIAL PLAN SCHEDULE "A8" (Arkona)

to By-law No. xx of 2015

Passed this xx day of xxxx, 2015

Bill Weber, Mayor

Carol McKenzie, Clerk

### Official Plan Amendments

OPA # xx, xxxxxx xx, 20xx

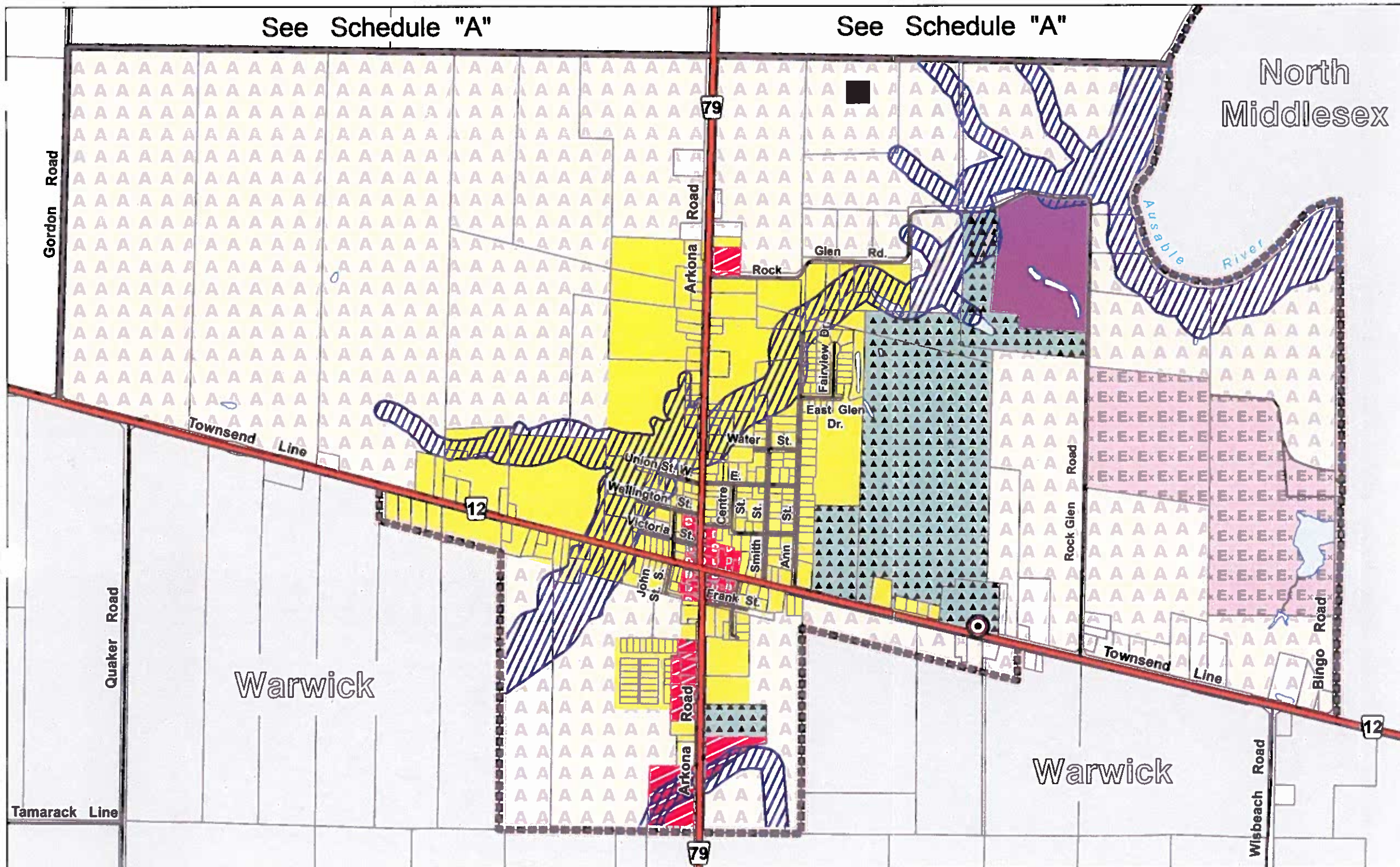

### LEGEND

- Assessment Parcels
- Rivers - Streams - Drainage
- Roads
- County Road
- Provincial Highway
- Railroad
- Cometary
- Waterbodies
- Sewage Treatment Works
- Active or Former Waste Disposal Site (Anderson Dataset - Lambton GWS 2004)
- Municipal Boundary
- Schedule Inset Boundary

### Official Plan - Designations

- Agriculture
- Residential
- Downtown Commercial
- Highway Commercial
- Campgrounds & Trailer Parks
- Extractive
- Open Space
- General Regulation Area

### Area Estimator

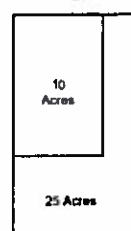

Notes: Area Estimator generalized blocks (shown at left) are scaled to represent typical area measures.

Area Estimator is properly scaled for Main Map ONLY.

Acres area measures can be converted to hectares (ha) by dividing by (2.471).

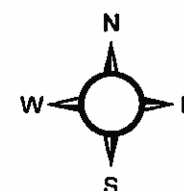

### Reference

Disclaimer: These digital mapping products have been produced on the County of Lambton's Geographic Information System. Data provided herein is derived from sources with varying levels of accuracy and currency. This is not a survey product. The County of Lambton disclaims all responsibility for the accuracy or completeness of information contained herein. The County of Lambton assumes no responsibility for errors arising from use of these digital mapping products.

The Official Plan information contained herein is current as of the last recorded amendment noted under "Official Plan Amendments"

- Cadestral database is current to June 2013.
- Wetlands database is current to June 2014 (MNR).
- General Regulation and Hazard Areas are determined by local Conservation Authorities and are Subject to Change (Dec 2013).

Projection: UTM NAD 83 Zone 17

COUNTY OF LAMBTON  
Planning and Development Services, October 2015

www.lambtononline.ca

