

## **APPENDIX B**

### **LAND USE PLANNING DOCUMENTS**

OFFICIAL PLAN  
OF THE  
MUNICIPALITY OF LAMBTON SHORES

SCHEDULE "A-1"  
GRAND BEND

LEGEND

- AGRICULTURE
- RESIDENTIAL
- RESIDENTIAL CONSTRAINT A
- COMMERCIAL
- URBAN DEVELOPMENT
- HARBOUR
- HAZARD AND ENVIRONMENTAL PROTECTION
- OPEN SPACE
- LAKESHORE

SCALE: 50 0 50 100 200 METRES

Amended OPA#3, May 5, 2003  
Amended OPA#18, June 3, 2008

PREPARED BY:  
COUNTY OF LAMBTON  
PLANNING AND DEVELOPMENT DEPARTMENT  
MAY, 2001

"SEE SCHEDULE A-2"

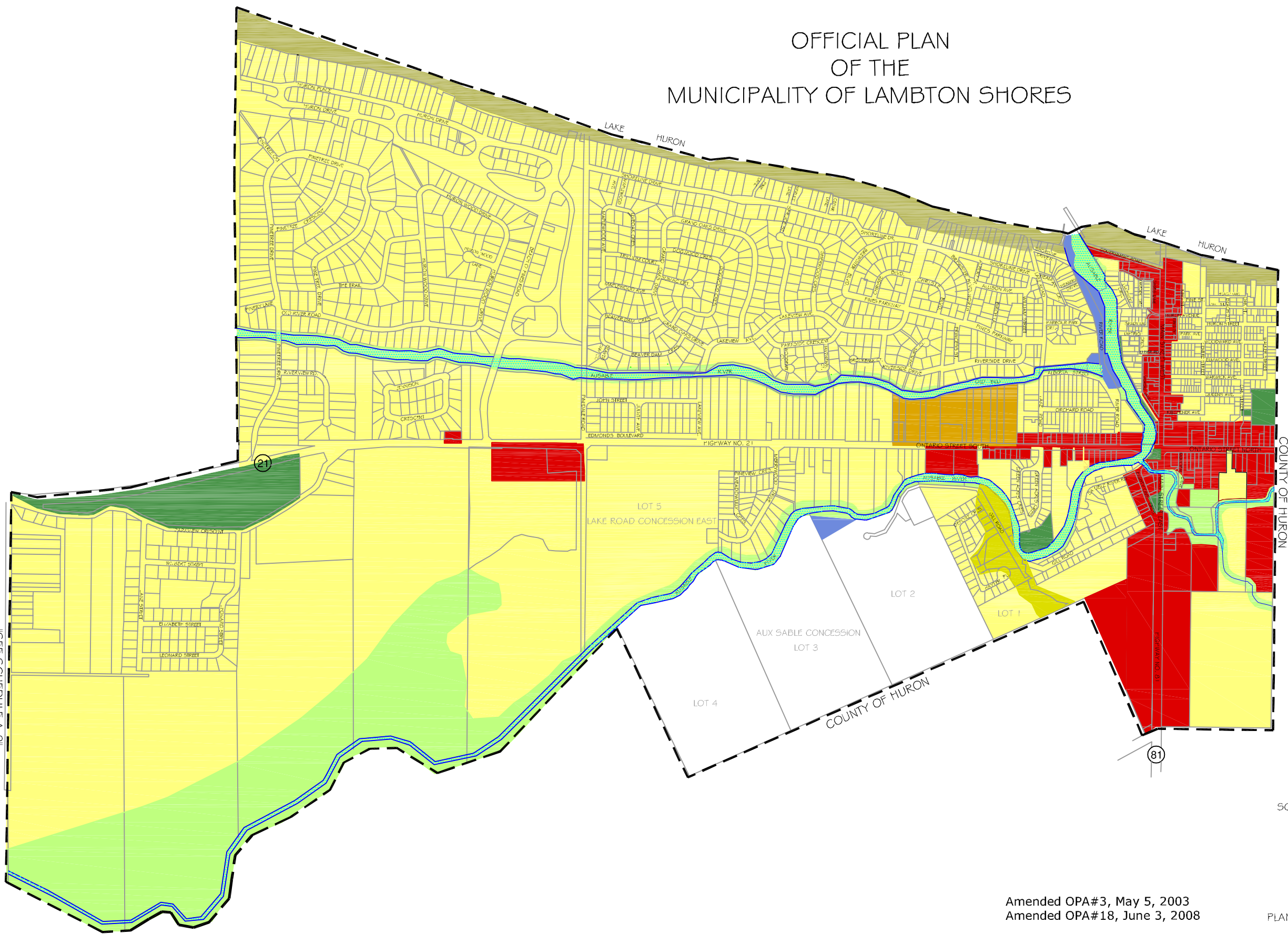

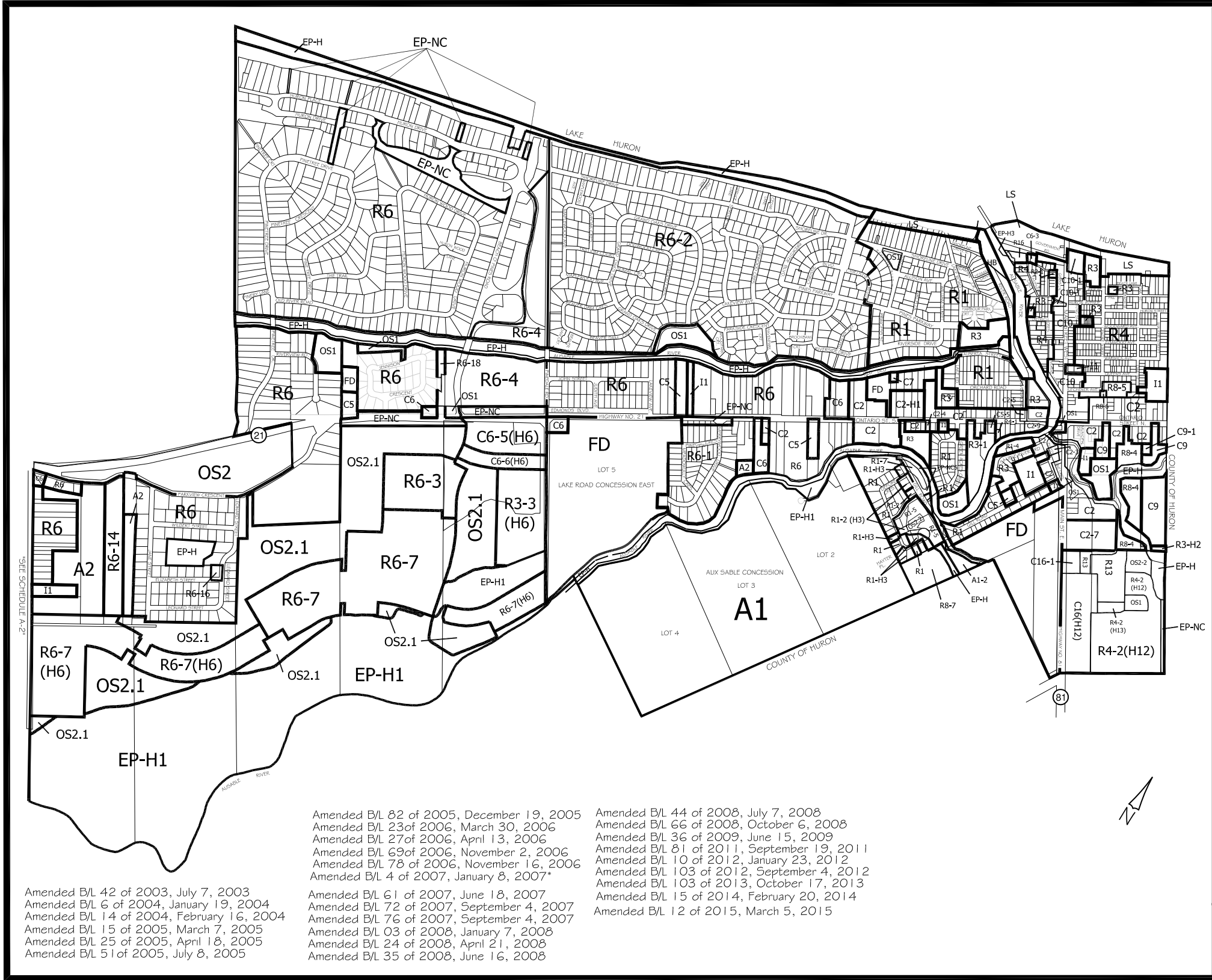

MUNICIPALITY OF LAMBTON SHORES  
SCHEDULE "A-1" (GRAND BEND)  
TO BY-LAW NO. 1 OF 2003

PASSED THIS 3 DAY OF February, 2003

J.C. IVEY, MAYOR

CAROL MCKENZIE, CLERK

LEGEND

SYMBOL	ZONE
A1	AGRICULTURAL - 1
A2	AGRICULTURAL - 2
C2	COMMERCIAL - 2
C3	COMMERCIAL - 3
C5	COMMERCIAL - 5
C6	COMMERCIAL - 6
C7	COMMERCIAL - 7
C9	COMMERCIAL - 9
C10	COMMERCIAL - 10
C16	COMMERCIAL - 16
EP-H	ENVIRONMENTAL PROTECTION - HAZARD
EP-NC	ENVIRONMENTAL PROTECTION - NATURAL CONSERVATION
FD	FUTURE DEVELOPMENT
HB	HARBOUR
I1	INSTITUTIONAL - 1
I2	INSTITUTIONAL - 2
LS	LAKESHORE
OS1	OPEN SPACE - 1
OS2	OPEN SPACE - 2
R1	RESIDENTIAL - 1
R3	RESIDENTIAL - 3
R4	RESIDENTIAL - 4
R6	RESIDENTIAL - 6
R8	RESIDENTIAL - 8
R10	RESIDENTIAL - 10
R13	RESIDENTIAL - 13
R16	RESIDENTIAL - 16
-H1,-H2..	HOLDING PROVISIONS
- 1,-2,..	EXCEPTIONS
- T,..	TEMPORARY BY-LAW

SCALE:  100 0 100 200 400 METRES

PREPARED BY:  
COUNTY OF LAMBTON  
PLANNING AND DEVELOPMENT DEPARTMENT  
FEBRUARY, 2003